

The bearing and distance down Delaware River areas followeth viz

- 1. S. 51. E.-----16.
 - 2 S. 32 E.-----31.
 - 3 S. 18. W.-----36
 - 4. S. 12 W.-----46
- 129.

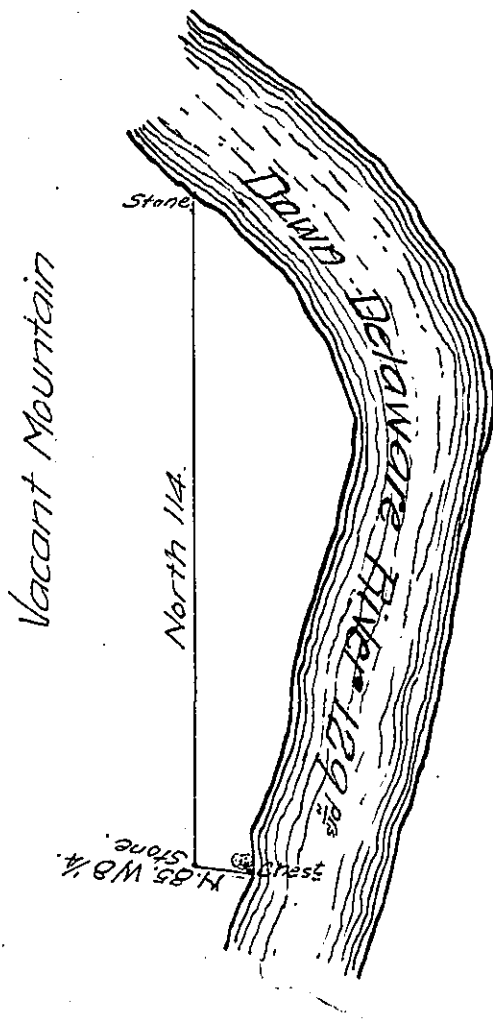

By Virtue of a Warrant dated the 3^d July 1784 Surveyed the 28th August 1794 to John Scott the above described tract of land situate on the South East side of the Blue mountain and on the West side of Delaware River in the County of Northampton Containing Eleven Acres an half and the allowance of Six $\frac{1}{2}$ Cent & ^a

Geo. Palmer D.S.

To Daniel Brodhead Esq^r }
Surveyor General. }

IN TESTIMONY that the above is a copy of the original remaining on file in the Department of Internal Affairs of Pennsylvania, made conformably to an Act of Assembly approved the 16th day of February, 1833, I have hereunto set my Hand and caused the Seal of said Department to be affixed at Harrisburg, this Seventeenth day of December 1906.

Leach R. Brown
Secretary of Internal Affairs.